

## Handcrafted Goes High Tech

### Background

With growing demand, local craftsman David Kurt ([www.dkurtnives.com](http://www.dkurtnives.com)) needed to find a new way to reproduce some of his hand crafted knife handles. The smooth shapes and precise edges would be a perfect candidate for reproducing on a CNC machine, so David came to GIS for help creating a new digital model for reproduction.



### Our Process

The original handles were cut and finished by hand from a solid block of composite material.

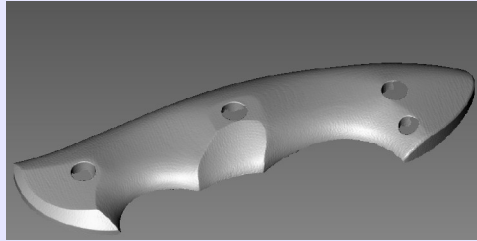

David provided us a set of hand finished handles for reproduction. The handles were digitally captured in 3D in our macro scanner to capture the smooth forms and sharp edges. From the scan, we were then able to recreate new CAD surfaces using the original sharp edges and 3D surfaces captured in the scan, to ensure that the new handles would fit right and feel right in the owners hands.

### The Results

We chose to reproduce the surfaces using high quality nurbs surfacing, trimmed to the original edges captured in the scan, to ensure the proper fit. This means our surfaces are perfectly smooth and free from defects at any scale, and they can just as easily be reproduced in wood, metal, or composite to a polished finish. Another perfect fit for from GIS 3D.

